

External Drive Piezo Element

SGBD-64PE Series



Dimensions

Top View

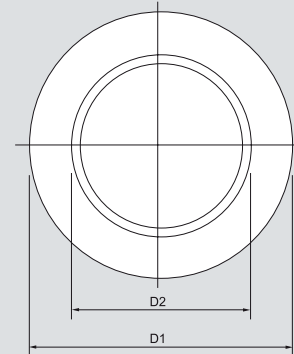

Side View

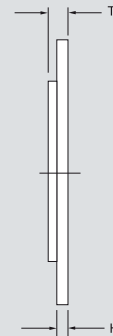

all dimensions are in mm

Electrical Specifications

Model	64PE061350	64PE121650	64PE151000
Diameter (D1) (Ømm)	6.5	12	15
Diameter (D2) (Ømm)	5	9	11
Metal Thickness (H) (mm)	0.1	0.2	0.2
Total Height (T) (mm)	0.23	0.41	0.39
Frequency (Hz)	13500 ± 2000	16500 ± 1500	10500 ± 1000
Resonant Impedance (Ω)	6000 Max.	600 Max.	500 Max.
Capacitance ± 30 % (pF)	2600	6000	8500

Model	64PE200710	64PE270330	64PE310290	64PE350280	64PE410150	64PE500130
Diameter (D1) (Ømm)	20	27	31	35	41	50
Diameter (D2) (Ømm)	15	20	20	25	25	30
Metal Thickness (H) (mm)	0.2	0.2	0.2	0.25	0.2	0.2
Total Height (T) (mm)	0.46	0.38	0.46	0.53	0.41	0.41
Frequency (Hz)	7000 ± 500	3300 ± 500	2900 ± 300	2800 ± 500	1500 ± 300	1100 ± 500
Resonant Impedance (Ω)	250 Max.	200 Max.	500 Max.	250 Max.	500 Max.	800 Max.
Capacitance ± 30 % (pF)	13000	35000	23000	40000	40000	60000