

**External Drive
Piezo Transducer**

SGBD-208PZ18200



Electrical Specifications

Model	208PZ18200	
Min. Sound Output (dBA)	75 min. (3.6V p-p / Square Wave / 10cm / 2000Hz)	
Capacitance (pF)	34000 ± 30% at 120Hz	
Max. Input Voltage (V p-p)	25	
Operating Temperature (°C)	-20 ~ +70	
Weight (g)	2	

Dimensions

Top View

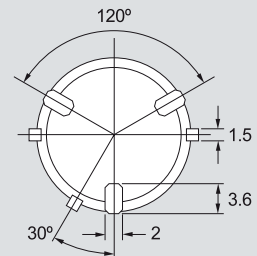

Side View

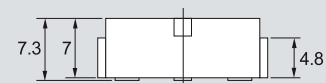

Bottom View

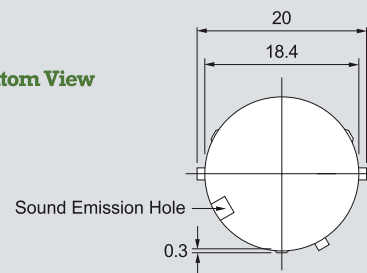

all dimensions are in mm

Frequency Response

