

NTC316 Series

■ Features

- Compact size 4.7x4.5mm.
- Horizontal direction.



Rating (max)	DC12V 50mA
Contact Resistance	100mΩ max.
Insulation Resistance	DC500V-100MΩ min.
Withstand Voltage	AC250V - 1 minute

Recommended Reflow Soldering Profile

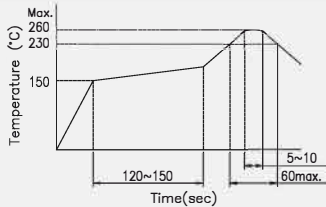

Recommended Manual Soldering Profile

Manual Soldering Temperature	Temperature	Time
	350 °C (max.)	3 Sec.(max.)

The solder iron and solder shall be applied at a distance of 1.91 mm to 2.54 mm from the plastic housing.

Operating Force & Durability

160 ± 50gf	200,000 cycles
220 ± 50gf	100,000 cycles

■ SMT - G Type Horizontal 4.7L x 4.5W x 1.65H [Without Ground Terminal]

Product No.	Stroke	Boss	Package
NTC316-AC1G-A160T	0.25 ± 0.1mm	With	3,300 Pcs/Reel
NTC316-AC1G-A220T	0.3 ^{+0.1} _{-0.2} mm	With	
NTC316-AD1G-A160T	0.25 ± 0.1mm	Without	
NTC316-AD1G-A220T	0.3 ^{+0.1} _{-0.2} mm	Without	

Schematic

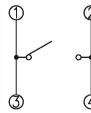

P.C.B Layout

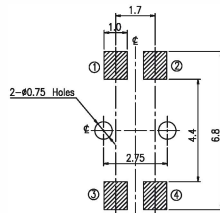

■ Outline Drawing

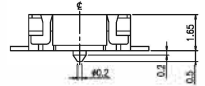
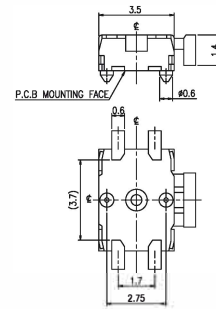
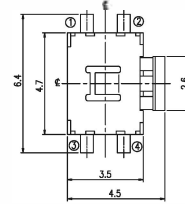

General Tolerance : ±0.2mm.

■ SMT - J Type Horizontal 4.7L x 4.5W x 1.65H [Without Ground Terminal]

Product No.	Stroke	Boss	Package
NTC316-AC1J-A160T	0.25 ± 0.1mm	With	3,300 Pcs/Reel
NTC316-AC1J-A220T	0.3 ^{+0.1} _{-0.2} mm	With	
NTC316-AD1J-A160T	0.25 ± 0.1mm	Without	
NTC316-AD1J-A220T	0.3 ^{+0.1} _{-0.2} mm	Without	

Schematic

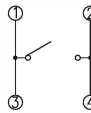

P.C.B Layout

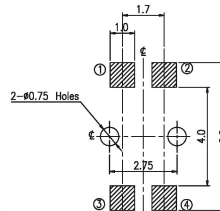

■ Outline Drawing

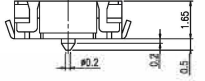
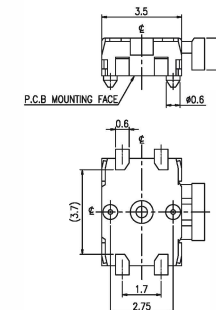
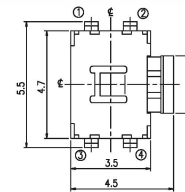

General Tolerance : ±0.2mm.

■ SMT - G Type Horizontal 4.7L x 4.5W x 1.65H [With Ground Terminal]

Product No.	Stroke	Boss	Package
NTC316-DC1G-A160T	0.25 ± 0.1mm	With	3,300 Pcs/Reel
NTC316-DC1G-A220T	0.3 ^{+0.1} _{-0.2} mm	With	
NTC316-DD1G-A160T	0.25 ± 0.1mm	Without	
NTC316-DD1G-A220T	0.3 ^{+0.1} _{-0.2} mm	Without	

Schematic

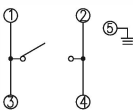

P.C.B Layout

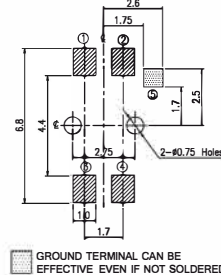

■ Outline Drawing

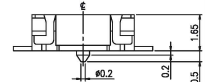
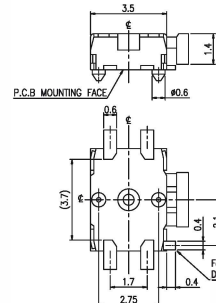
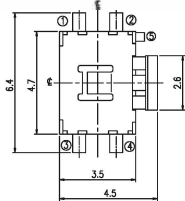

General Tolerance : ±0.2mm.

■ SMT- J Type Horizontal 4.7L x 4.5W x 1.65H [With Ground Terminal]

Product No.	Stroke	Boss	Package
NTC316-DC1J-A160T	0.25 ± 0.1mm	With	3,300 Pcs/Reel
NTC316-DC1J-A220T	0.3 $^{+0.1}_{-0.2}$ mm	With	
NTC316-DD1J-A160T	0.25 ± 0.1mm	Without	
NTC316-DD1J-A220T	0.3 $^{+0.1}_{-0.2}$ mm	Without	

■ Outline Drawing

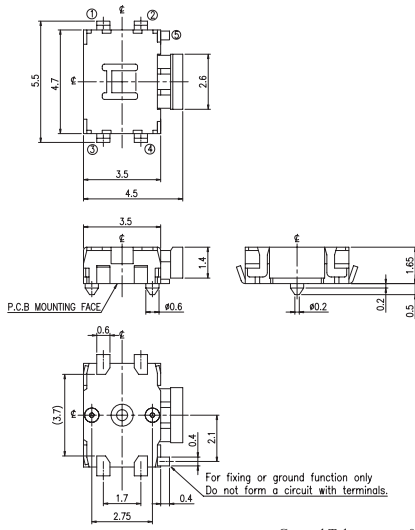

Schematic

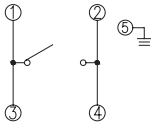

P.C.B Layout

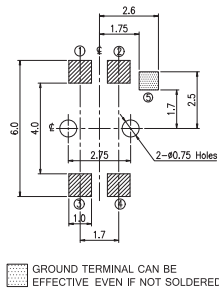

General Tolerance : ±0.2mm.

