

# NTC311 Series

## Features

- Compact size 3.5x3.55mm.
- Horizontal direction.

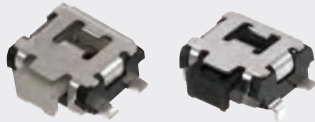

Rating (max)	DC12V 50mA
Contact Resistance	500mΩ max.
Insulation Resistance	DC500V-100MΩ min.
Withstand Voltage	AC250V - 1 minute
Stroke	0.2 <sup>+0.2</sup> <sub>-0.1</sub> mm

### Recommended Reflow Soldering Profile

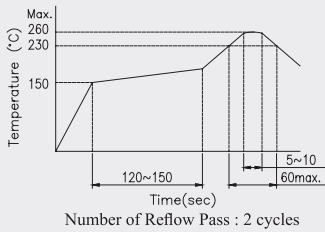

### Recommended Manual Soldering Profile

	Temperature	Time
Manual Soldering Temperature	350 °C (max.)	3 Sec.(max.)

The solder iron and solder shall be applied at a distance of 1.91 mm to 2.54 mm from the plastic housing.

### Operating Force & Durability

160 <sup>+70</sup> <sub>-40</sub> gf	100,000 cycles
220 <sup>+80</sup> <sub>-70</sub> gf	100,000 cycles

## SMT - G Type Horizontal 3.5L x 3.55W x 1.35H [ Without Ground Terminal ]

Product No.	Boss	Package
NTC311-EC1G-A__T	Without	3,500 Pcs/Reel
NTC311-ED1G-A__T	With	

### Schematic

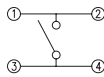

### P.C.B Layout

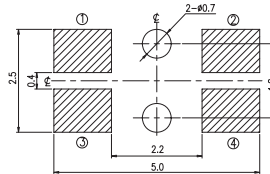

### Outline Drawing

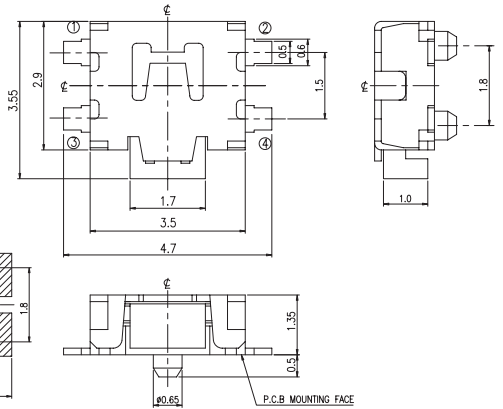

General Tolerance : ±0.2mm.

## SMT - T Type Horizontal 3.5L x 3.55W x 1.35H [ Without Ground Terminal ]

Product No.	Boss	Package
NTC311-EC1T-A__T	With	3,500 Pcs/Reel

### Schematic

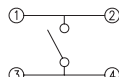

### P.C.B Layout

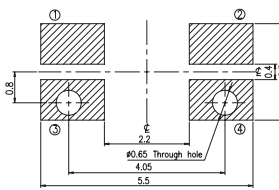

### Outline Drawing

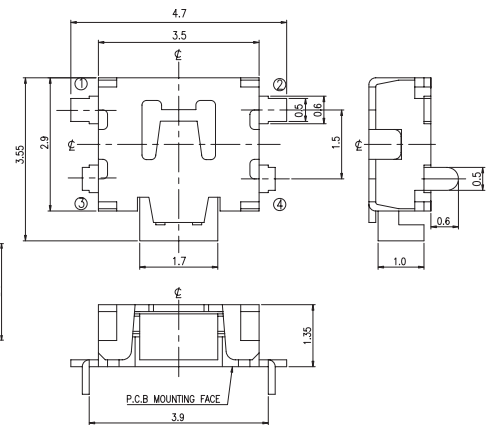

General Tolerance : ±0.2mm.

## SMT - G Type Horizontal 3.5L x 3.55W x 1.35H [ With Ground Terminal ]

Product No.	Boss	Package
NTC311-FC1G-A__T	Without	3,500 Pcs/Reel
NTC311-FD1G-A__T	With	

### Schematic

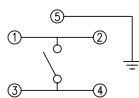

### P.C.B Layout

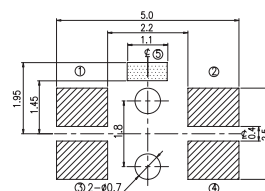

### Outline Drawing

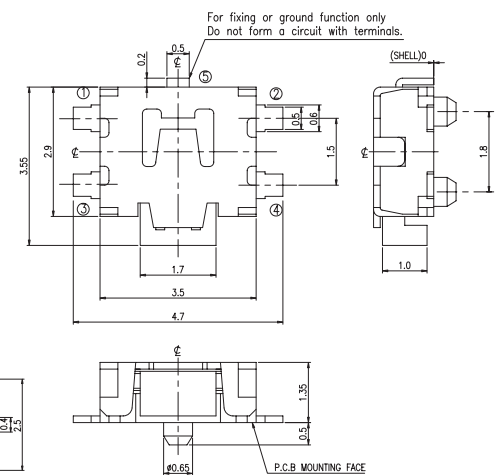

GROUND TERMINAL CAN BE EFFECTIVE EVEN IF NOT SOLDERED.

General Tolerance : ±0.2mm.

■ SMT - T Type Horizontal 3.5L x 3.55W x 1.35H  
 [ With Ground Terminal ]

■ Outline Drawing

Product No.	Boss	Package
NTC311-FC1T-A__T	With	3,500 Pcs/Reel

