

External Drive Piezo Transducer

SGBD-188PZ22400



Electrical Specifications

Model	188PZ22400	
Min. Sound Output	(dBA)	90 min. (12V p-p / Square Wave / 10cm / 4000Hz)
Capacitance	(pF)	15000 ± 30% at 120Hz
Max. Input Voltage	(V p-p)	30
Operating Temperature	(°C)	-20 ~ +70
Weight	(g)	2.8

Frequency Response

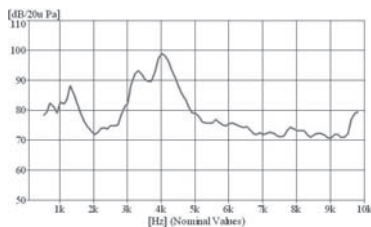

Dimensions

Top View

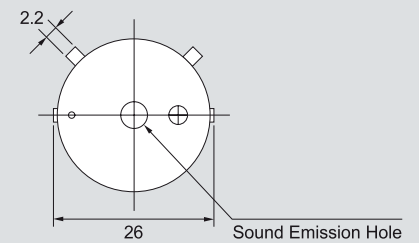

Side View

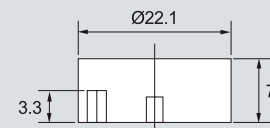

Bottom View

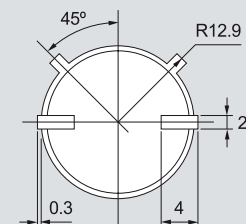

all dimensions are in mm