

TACT SWITCH DISD-11TC88

3.5x7
SMT & Side Push Type

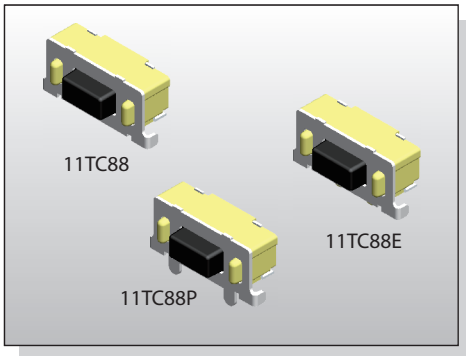

FEATURES

- ※ Side actuated
- ※ Support / Ground pins options
- ※ High solder strength

APPLICATION

- ※ Audio, OA equipment
- ※ Instrumentation
- ※ Remote control

SPECIFICATION

Contact Rating	50mA, 12V DC
Contact Resistance	100mΩ max.
Insulation Resistance	100MΩ min. 500V DC
Dielectric Strength	250V AC/1 minute
Operating Force	160±50gf/260±50gf
Travel	0.25±0.1mm
Operating Life	30,000 cycles for 260gf 50,000 cycles for 160gf
Operating Temp.	-25°C ~ +70°C
Storage Temp.	-40°C ~ +80°C

HOW TO ORDER

DISD-11TC88-□□-□□

□=Without Post
E=Base with Post
P=Cover with Support Bracket
EP=Base+Cover with Post & Support Bracket

K=Black
W=White

Package:
T/R=Tape & Reel

Operating Force:
2=160gf
3=260gf

CIRCUIT

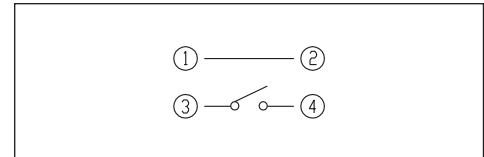

PACKAGE

<Tape & Reel>
2000 pcs

DISD-11TC88

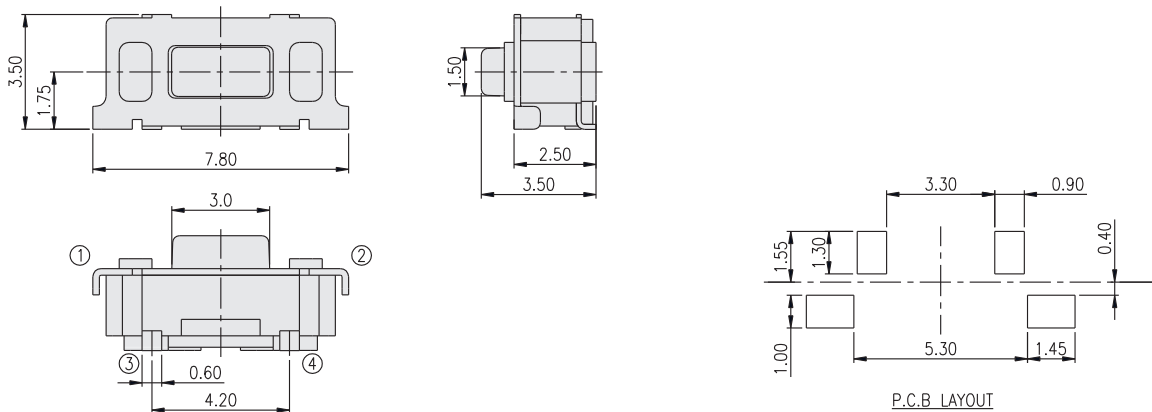

DISD-11TC88-E

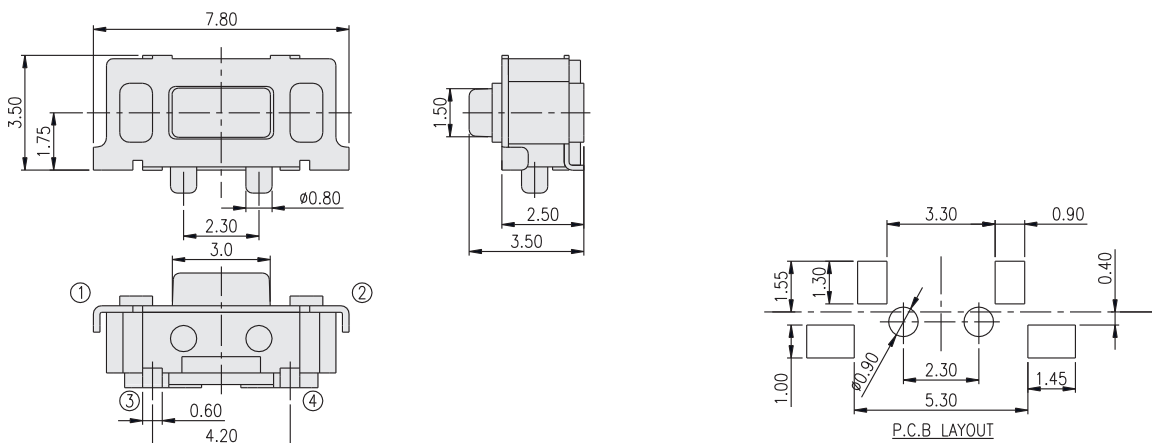

TACT SWITCH DISD-11TC88

3.5x7
SMT & Side Push Type

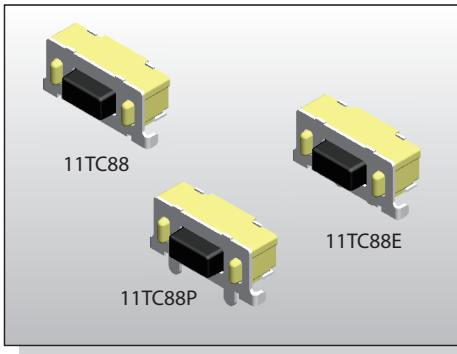

FEATURES

- ※ Side actuated
- ※ Support / Ground pins options
- ※ High solder strength

APPLICATION

- ※ Audio, OA equipment
- ※ Instrumentation
- ※ Remote control

SPECIFICATION

Contact Rating	50mA, 12V DC
Contact Resistance	100mΩ max.
Insulation Resistance	100MΩ min. 500V DC
Dielectric Strength	250V AC/1 minute
Operating Force	160±50gf/260±50gf
Travel	0.25±0.1mm
Operating Life	30,000 cycles for 260gf 50,000 cycles for 160gf
Operating Temp.	-25°C ~ +70°C
Storage Temp.	-40°C ~ +80°C

HOW TO ORDER

DISD-11TC88-□□-□□

□=Without Post
E=Base with Post
P=Cover with Support Bracket
EP=Base+Cover with Post & Support Bracket

K=Black
W=White

Package:
T/R=Tape & Reel

Operating Force:
2=160gf
3=260gf

CIRCUIT

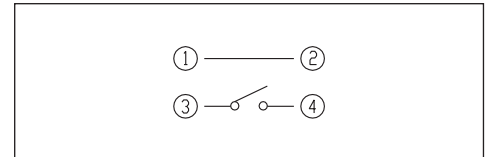

PACKAGE

<Tape & Reel>
2000 pcs

DISD-11TC88P

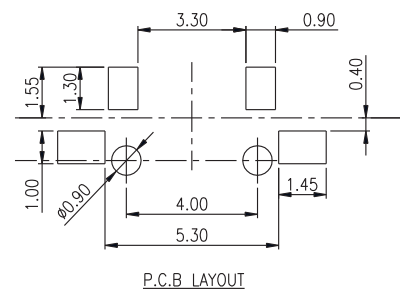
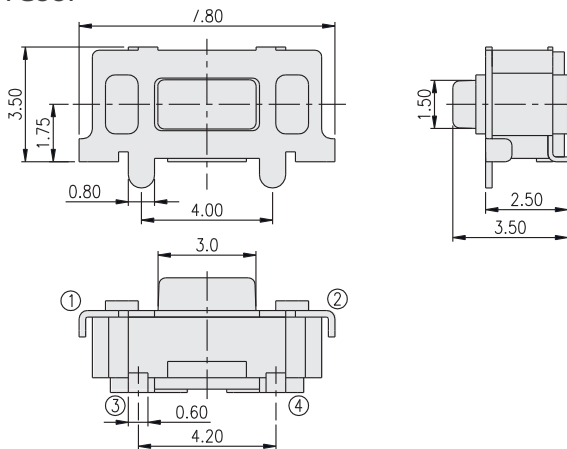

DISD-11TC88EP

